

4611110015368

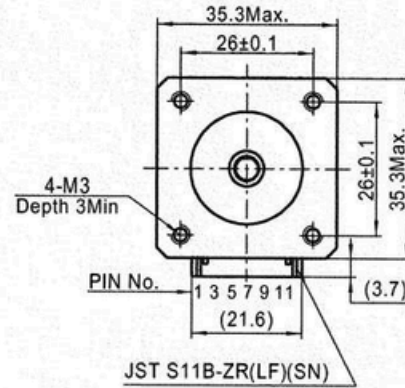

Wiring Diagram

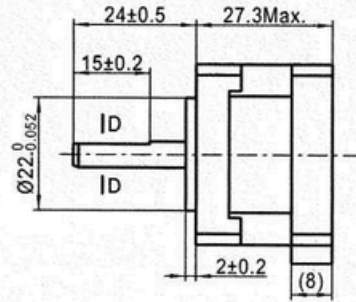
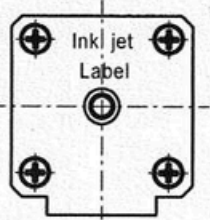
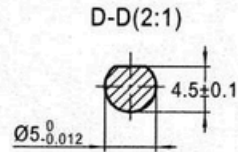
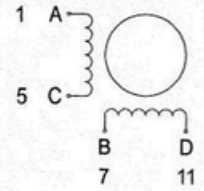

Exciting Sequence vs. Direction of Rotation

STEP	A	B	C	D	CCW
1	+	+	-	-	↑
2	-	+	+	-	
3	-	-	+	+	
4	+	-	-	+	

Clockwise view from mounting side

Specifications

1. Number of Phase	2
2. Step Angle	1.8°
3. Rated Voltage	2.33V DC
4. Rated Current	1.5Amp
5. Holding Torque	140mN.m Typ.(Two phase on/rated current)
6. Phase Resistance	1.55hm±10%(20°C)
7. Phase Inductance	1.8mH±20%(1kHz 1V rms)
8. Rotor Inertia	12g.cm ²
9. Motor Weight	150g
10. Insulation Class	B(130°C)

Label Detail

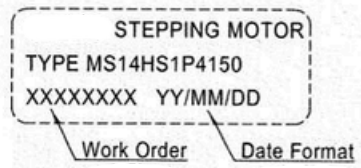

Unit: mm
 FIRST ANGLE METHOD
 Tolerance for linear and regular dimension without individual tolerance indications GB/T 1804-m egv ISO 2768-1: m
 Geometrical tolerance for features without individual tolerance indications GB/T 1184-K egv ISO 2768-2: K

Approve	
Standard	
Technology	
Check	
Design	

PIVEXIN
TECHNOLOGY

REV.	REVISION RECORD	DATE
A	Original revision	2016.06.23